

Motion detector

Model Name: **Ajax MotionProtect Outdoor**

Wireless outdoor motion detector with protection against masking

MotionProtect Outdoor is a wireless outdoor motion detector with protection against masking and false triggering. It is connected to the Ajax security system via Jeweller protected protocol, with a transmission distance of up to 1,700 m in the absence of obstacles. The detector can operate on batteries or from an external power source for up to 5 years. The device detects motion at a distance of up to 15 m and ignores pets.

The detector only operates with ajax hubs. Connection to ocBridge and uartBridge integration modules is not provided.

IMPORTANT: This Quick Start Guide contains general information about the MotionProtect Outdoor. Before using the device, we recommend to reviewing the User Manual on the website: ajax.systems/ru/support/devices/motionprotectoutdoor

FUNCTIONAL ELEMENTS

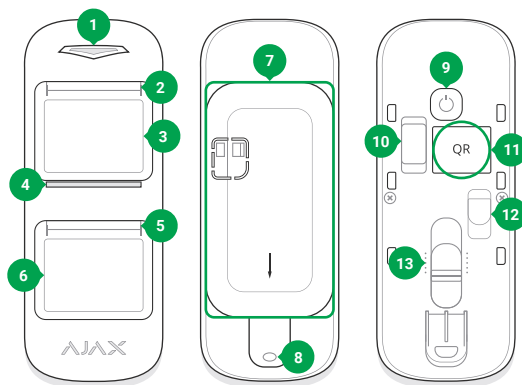

- 1 - Main light indicator
- 2 - Upper light indicator and masking sensor
- 3 - Upper motion sensor lens
- 4 - Varnish masking sensor
- 5 - Lower light indicator and masking sensor
- 6 - Lower motion sensor lens
- 7 - SmartBracket attachment panel (the perforated part is necessary for tamper activation when attempting to pull the detector away from the surface)
- 8 - Hole for attaching SmartBracket panel with a screw
- 9 - "On" button
- 10 - Tamper button
- 11 - QR Code
- 12 - Connector for external power supply cable outlet
- 13 - Scroll bar for adjusting detection range

CONNECTION

The MotionProtect Outdoor is connected to the hub and set up via the Ajax Security system mobile application. Remove the SmartBracket attachment panel, locate the device and the Hub within the communication range and follow the device connection procedure.

To avoid masking alarms, switch off anti-masking in the device settings prior to installation.

CHOOSING AN INSTALLATION PLACE

The MotionProtect Outdoor must be located at a height of 0.8 – 1.3 m. The detector body is located in a way that the upper lens axis is parallel to ground level and the supposed path of intruder entry passes perpendicular to the lens axis.

The MotionProtect Outdoor sends an alarm to the hub only if identical motion signals are detected with two PIR sensors. In this case, the difference in motion capture time shall not exceed 1.5 seconds in this case.

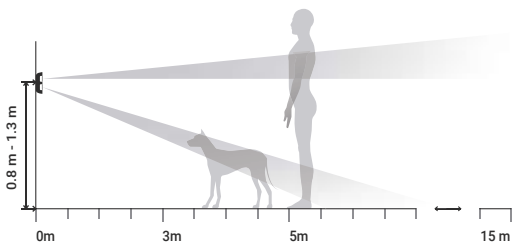

Prior to mounting the device with wood screws, perform a signal strength test in the AjaxSecurity System application for at least one minute to check the communication quality between the detector and the Hub.

Status of the main indicator		Signal level
Lights with interruptions once every 1.5 seconds		Excellent signal level
Blinks 5 times per second		Good signal level
Blinks 2 times per second		Poor signal level
Lights up for a short time once every 1.5 seconds		No signal

DEVICE CONNECTION AND SETTING

1. Temporarily fix the SmartBracket attachment panel on the surface to determine the optimal place for installing the detector.
2. Select the required detection distance (3 to 15 m) for the detector with the detection distance adjustment scroll bar.

This product can be used across all EU member states.

This device in compliance with the essential requirements and other relevant provisions of Directive 2014/53/EU. All essential radio test suites have been carried out.

DEVICE CONNECTION AND SETTING

3. Put the MotionProtect Outdoor on the SmartBracket attachment panel. Leave the detector detection area (horizontal detection angle – 90°) and ensure that there is no motion within the detection coverage area to provide for calibration of masking sensors.

Attention! The masking sensors will begin to calibrate automatically when the SmartBracket attachment panel is placed onto the MotionProtect Outdoor body. Calibration lasts up to 30 seconds and is followed by flashing of the upper and lower LED indicators of the detector.

4. Perform detection area and masking tests in the Ajax Security System application.

5. Fasten the SmartBracket attachment panel to the surface with wood screws, place the detector on the attachment panel and wait until calibration is complete. Fix the detector on the attachment panel with the bundled screw.

EXTERNAL POWER SUPPLY CONNECTION

The MotionProtect Outdoor can use external power supply 5-28 V DC, 200 mA. In that case, the bundled batteries will provide the device with standby power supply.

To connect the external power supply, unscrew the wood screws and open the detector body.

Break off the corresponding blind plug of the SmartBracket attachment panel:

1. For power supply cable outlet behind the SmartBracket attachment panel
2. For power supply cable outlet below the SmartBracket attachment panel

Run the external power supply dead cable through the attachment panel and blind plug on the back of the detector body.

Connect the cable to the terminal strips observing polarity. Fix the wires with a clamp.

Turn on the power – in the menu of the MotionProtect Outdoor detector, the value of the «External Power Supply» field will change to «Connected». Fasten the rear of the body with wood screws, install the detector and wait until calibration is complete.

3. Terminal strips on the detector board
4. Clamp on the back of the body

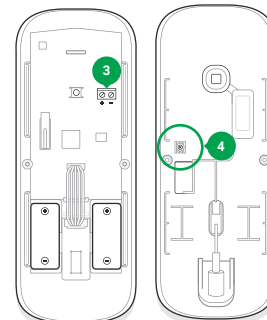
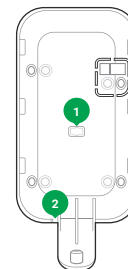
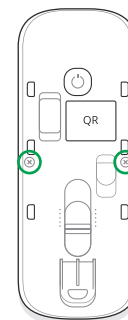

TECH SPECS

Sensitive element	PIR sensor, 2 pcs
Detection angle, horizontal	90°
Motion detection distance	Adjustable, 3–15 m when the detector is installed at 1 m height
Protection against masking	Yes
Pet ignoring function	Yes, height up to 80 cm when the detector is installed at 1 m height
Protection against false alarms	Yes, algorithmic analysis
Frequency band	868.0–868.6 MHz or 868.7–869.2 MHz, depending on the sales region
Effective radiated power	13 dBm, Up to 20 mW
Radio signal modulation	GFSK
Radio signal range	Up to 1,700 m (any obstacles absent)
Power supply	2 x CR123A, 3 V
Battery life	Up to 5 years
External power	5–28 V DC, 200 mA
Usage	Indoors and outdoors
Body protection level	IP54
Anti-tamper switch	Yes
Operating temperature range	From -25°C to +60°C
Operating humidity	Up to 95%
Overall dimensions	183 x 70 x 65 mm
Weight	322 g

WARRANTY

Warranty for Ajax devices is valid for two years after the purchase date and does not apply to the supplied battery. If the device does not work correctly, you should first contact the support service—in half of the cases, technical issues can be solved remotely!

The full text of the warranty is available on the website:

ajax.systems/warranty

User Agreement: ajax.systems/end-user-agreement

Technical support: support@ajax.systems

COMPLETE SET

1. MotionProtect Outdoor
2. Battery CR123A (pre-installed) - 2 pcs
3. Installation kit
4. Quick Start Guide

Manufacturer: "AJAX SYSTEMS MANUFACTURING"
LIMITED LIABILITY COMPANY
Address: Skityarenko 5, Kyiv, 04073, Ukraine

www.ajax.systems



CAUTION: RISK OF EXPLOSION IF BATTERY IS REPLACED BY AN INCORRECT TYPE. DISPOSE OF USED BATTERIES ACCORDING TO THE INSTRUCTIONS